

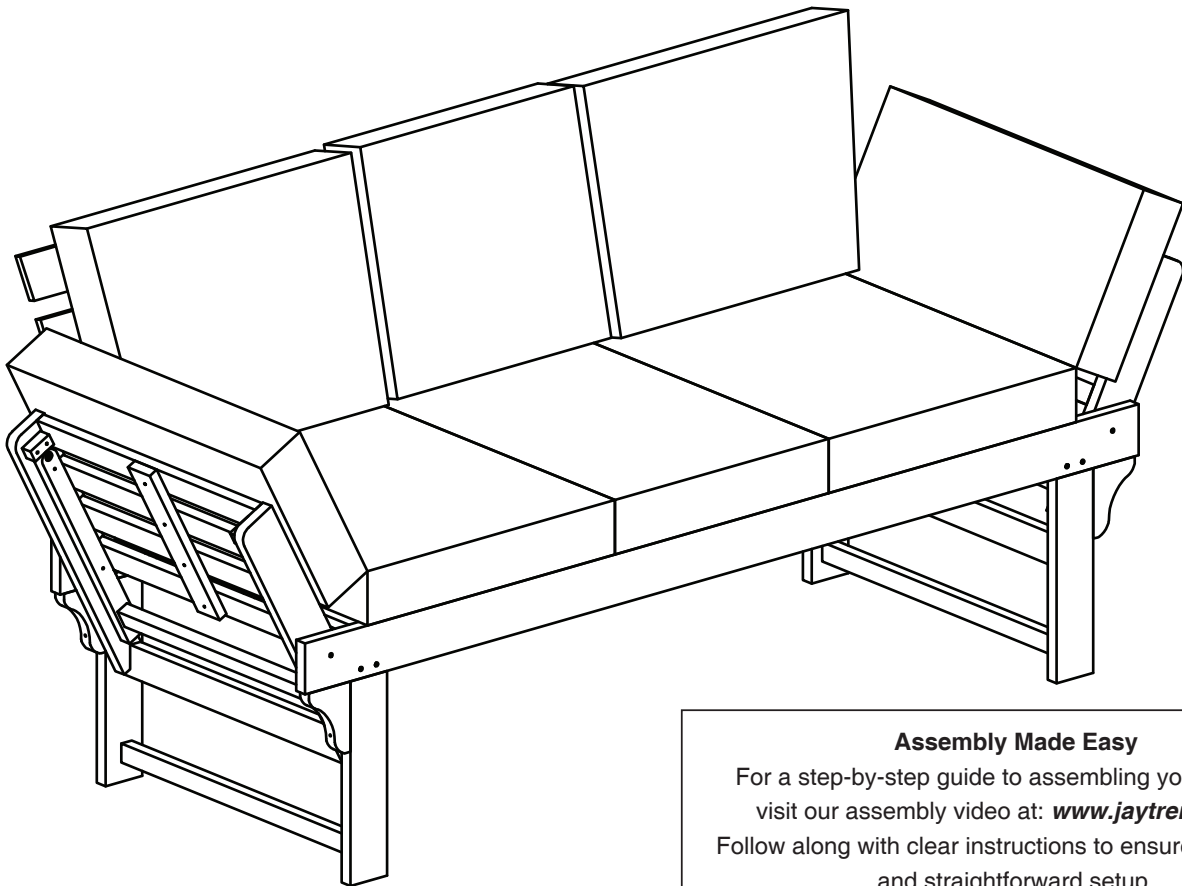

Item # 8762

## Woodland Duo Bench with foldable middle table



### Assembly Made Easy

For a step-by-step guide to assembling your product, visit our assembly video at: [www.jaytrends.com](http://www.jaytrends.com)  
Follow along with clear instructions to ensure an efficient and straightforward setup.

Thank you for purchasing your new wood bench

Should you encounter problems after following all the steps herein contained please contact our Customer Service: 1-877-387-3639 in USA & Canada or by email [custserv@jaytrends.com](mailto:custserv@jaytrends.com)

DO NOT RETURN THIS ITEM TO THE STORE



**IMPORTANT, RETAIN FOR FUTURE REFERENCE: READ CAREFULLY**



# Owner's Manual

# General Information

Before beginning assembly of product, make sure all parts are present. Compare parts with package contents list. If any parts are missing or damaged, do not attempt to assemble the product.



**WARNING**  
FOR YOUR SAFETY

For Outdoor Use Only

**Installer:** Leave these instructions with the consumer.

**Consumer:** Keep these instructions for future reference.



**WARNING**  
FOR YOUR SAFETY

1) Improper installation, adjustment, alteration, service or maintenance can cause injury or property damage.

2) Read the installation, operation, and maintenance instructions thoroughly before installing or servicing this equipment.

3) Failure to follow these instructions could result in property damage, personal injury or death.

## LIMITED WARRANTY

This product has a ninety (90) days Limited Warranty. This warranty is limited to the replacement of defective parts only. Labor charges and/or damage incurred during installation, repair, replacement as well as incidental and consequential damages connected with the above are excluded. Any damage to this product as a result of neglect, misuse, accident, improper installation or use other than the purpose SHALL VOID THIS WARRANTY.

## Useful Information

- This appliance is for outdoor use only.
- The assembling of the item should be done by 2 persons.
- Be careful, danger of shearing and pinching during installation.
- To be installed on a firm level floor.
- Do not stand and/or not jump on the articles.
- Regularly check the tightness of bolts, screws and fasteners.
- All above must be exactly followed.

## Care Instructions

- Wipe clean with a damp cloth. Use only clean water.
- Dust and dirt can be vacuum cleaned or wiped with a clean soft cloth.
- Do not use detergents, solvents or other chemicals on fabric as this may cause discoloration.

## Assembly Safety Notes

- First slightly fasten screws.
- Take care that the product stands firmly and evenly, adjust if necessary.
- Finally tighten screws after all screws are in place.
- Check screws and bolts monthly. Tighten if necessary.

# Package & Hardware Contents

Before beginning assembly of product, make sure all parts are present. Compare parts with package contents list. If any parts are missing or damaged, do not attempt to assemble the product.

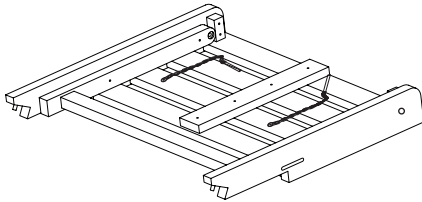

**I = 2pcs**

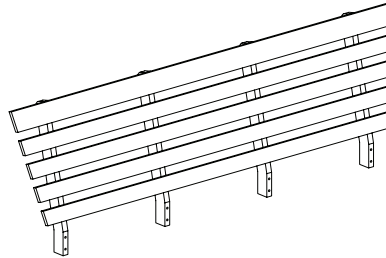

**V = 1pc**

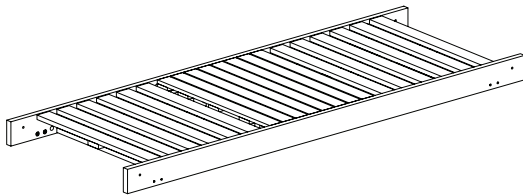

**II = 1pc**

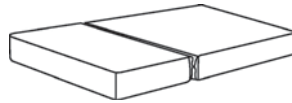

**VI = 2pcs**

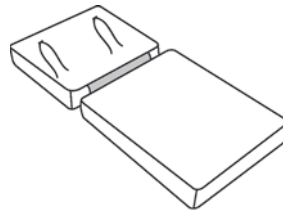

**VII = 1pc**

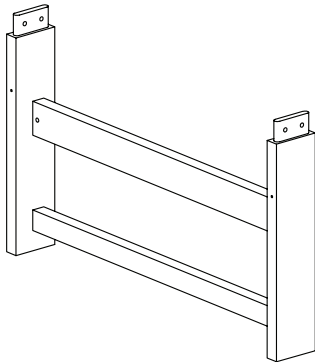

**III = 2pcs**

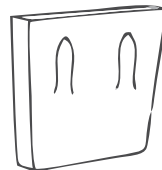

**VIII = 1pc**

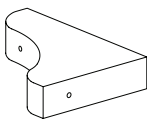

**VI = 4pcs**

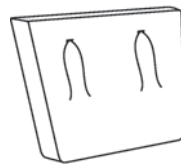

**IX = 1pc**



**X = 1pc**

**(A)**



Bolt M6x15

x 8pcs

**(B)**

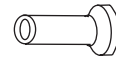

M6x13x15

x 8pcs

**(C)**

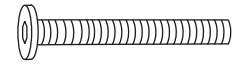

Bolt M8x35

x 4pcs

**(D)**



Washer M20x8.5x2

x 4pcs

**(E)**

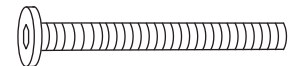

Bolt M8x45

x 8pcs

**(F)**

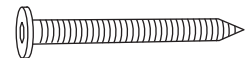

M6x60

x 8pcs

**(G)**



Allen key 4

x 2pcs

# Assembly

**1**

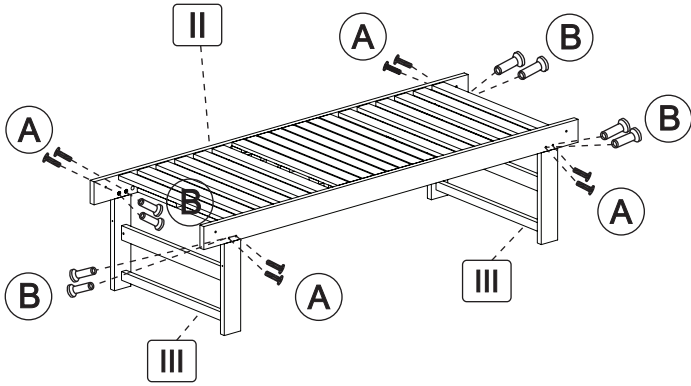

**2**

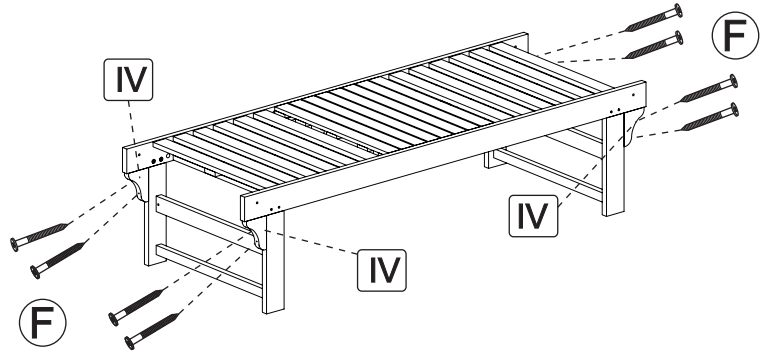

**3**

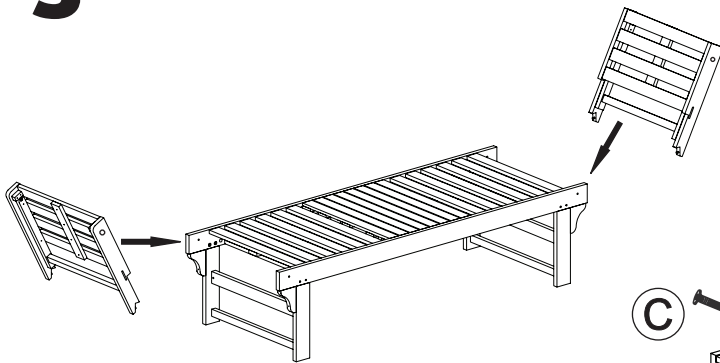

**4**

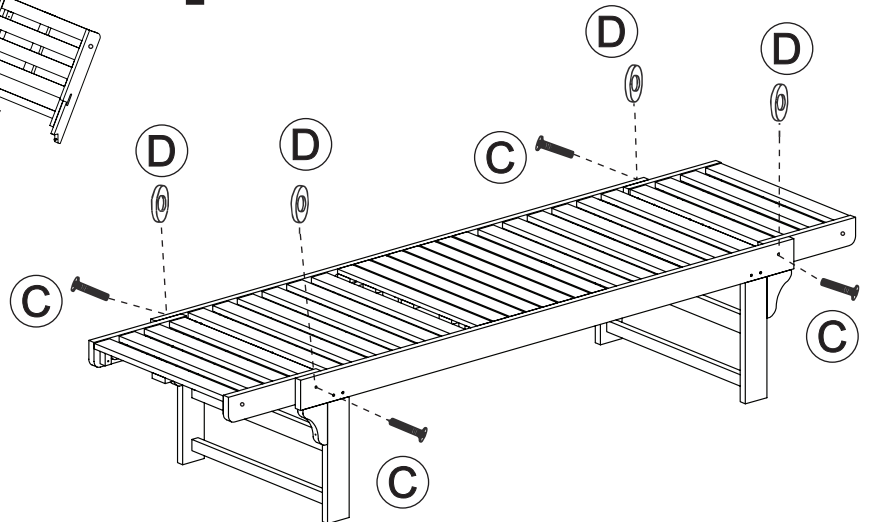

# Assembly

**5**

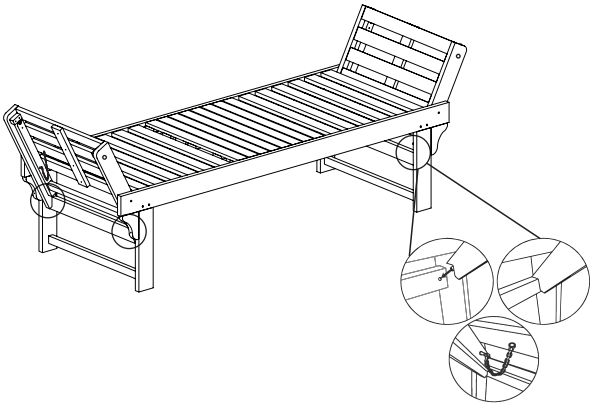

**6**



**7**

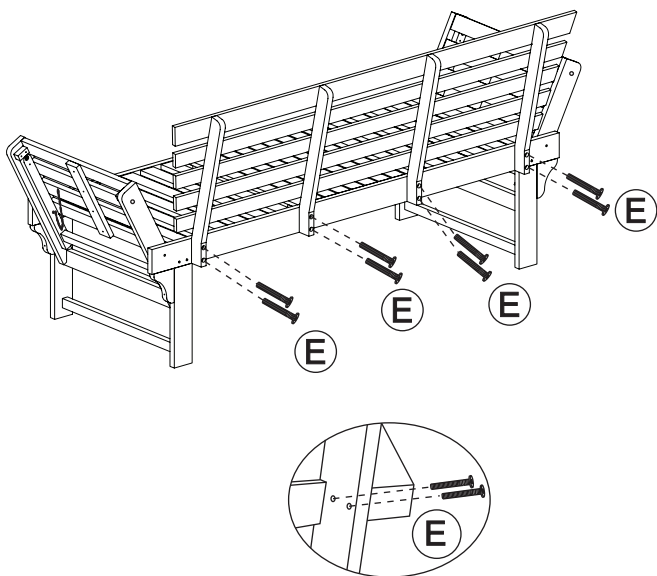

**8**

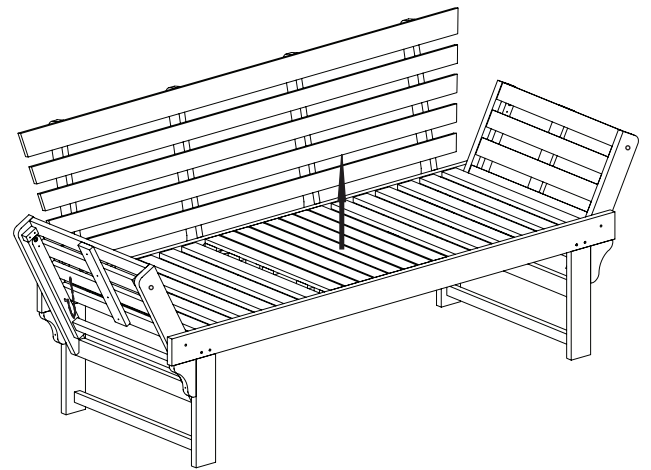

# Assembly

## 9

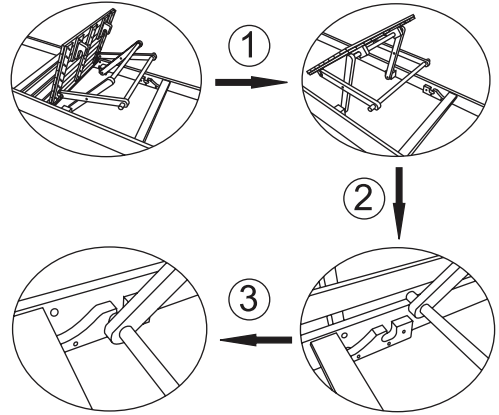
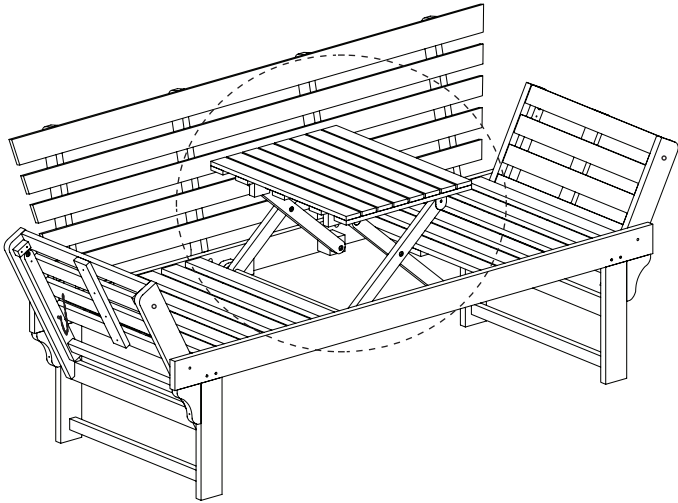

## 10

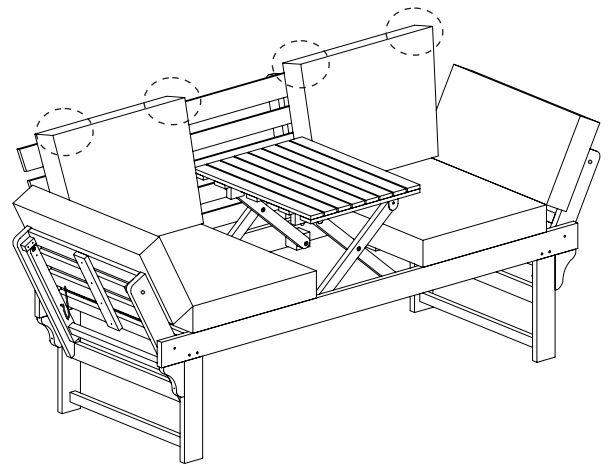
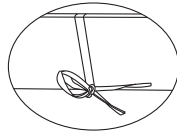
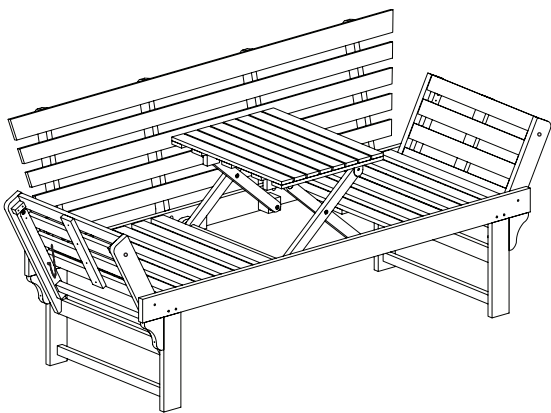

# Assembly

## 11

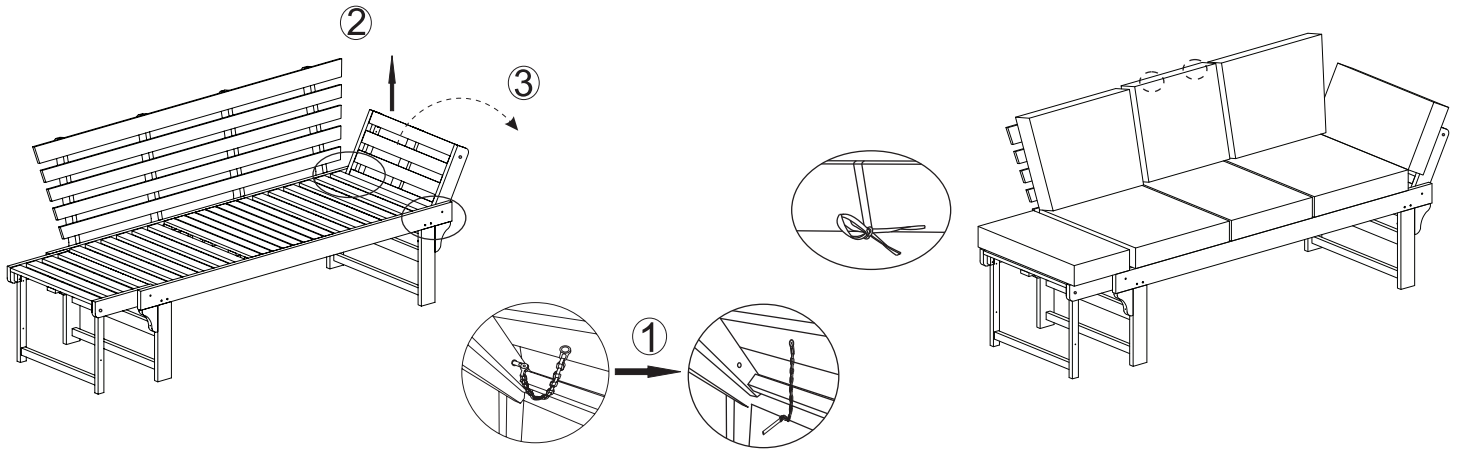

## 12

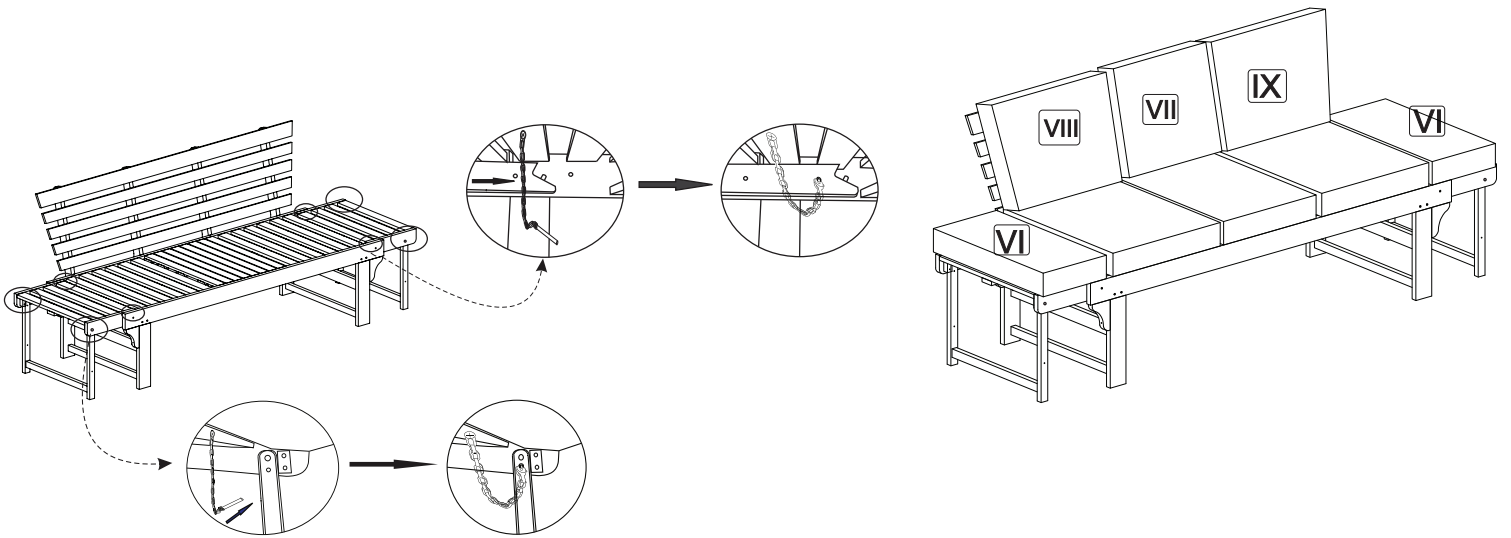

## 13

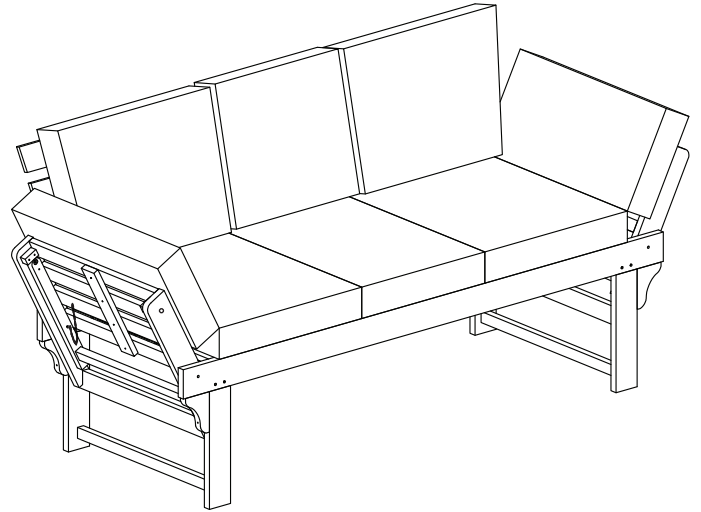
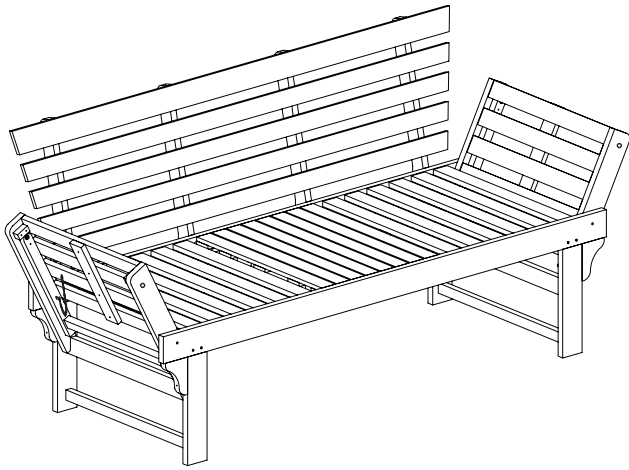

# Care & Maintenance

## **Wood Care Guidelines - Tips for Cleaning Hardwood Furniture:**

You have purchased a durable, weather-resistant piece of furniture made from Acacia hardwood. Its surface has been treated with environmentally friendly hardwood oil. Since wood is a living material, small cracks and gradual discoloration (the wood may turn silver-grey over time due to weather exposure) are normal for hardwoods. To maximize the longevity of your furniture, follow these care instructions:

### **Care:**

This garden furniture has been oiled before leaving the factory. Since oil penetrates differently into various types of wood, please wipe away any excess oil and dust with a cloth before first use. Do not apply oil to your new furniture right away. We recommend cleaning your furniture at the end of the first garden season. If needed, lightly sand the surface using very fine sandpaper (400 grit) and apply a thin layer of oil with a cloth to restore its color. Wipe off any excess oil with a dry cloth. Repeat this process annually, just before placing the furniture outdoors for the summer.

Exposure to rain may cause the surface to become slightly wavy or rough. Wood naturally shrinks and expands with humidity, which is normal. In rare cases, wood tannin (a natural colorant) may be released during rainfall, potentially staining unsealed patio tiles or clothing. This is a natural characteristic of colored woods and is not a cause for concern.

### **Winter Storage:**

Avoid storing your furniture in centrally heated rooms, as this can cause the wood to dry out, crack, or shrink. The ideal storage location is a cool, well-ventilated garden shed. Avoid covering the wood with plastic, as it may lead to mold. After prolonged use, or if the wood dries out, retightening the screws with moderate force may be necessary. Use an Allen key for this task.

# Storage

1

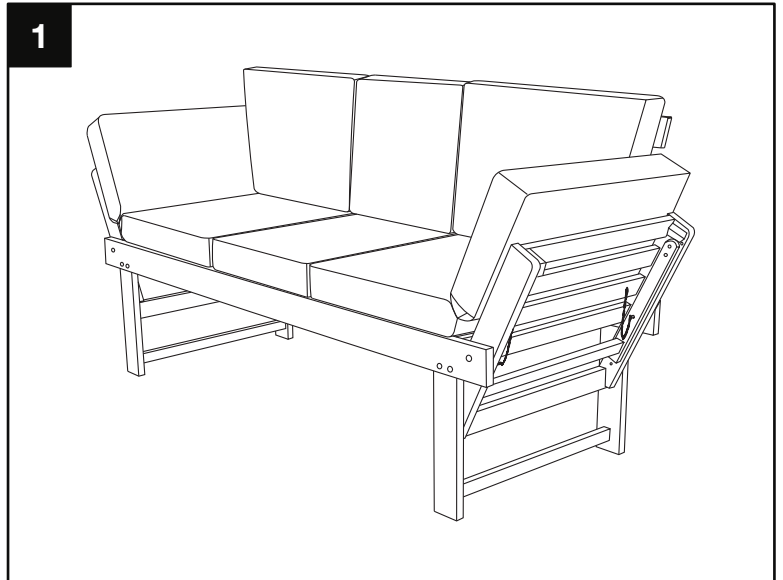

2. Cover the Woodland Duo Bench with protective cover (X) to protect the exterior surfaces.

Winter Storage: Avoid storing your furniture in centrally heated rooms, as this can cause the wood to dry out, crack, or shrink. The ideal storage location is a cool, well-ventilated garden shed. Avoid covering the wood with plastic, as it may lead to mold. After prolonged use, or if the wood dries out, retightening the screws with moderate force may be necessary. Use an Allen key for this task.

2

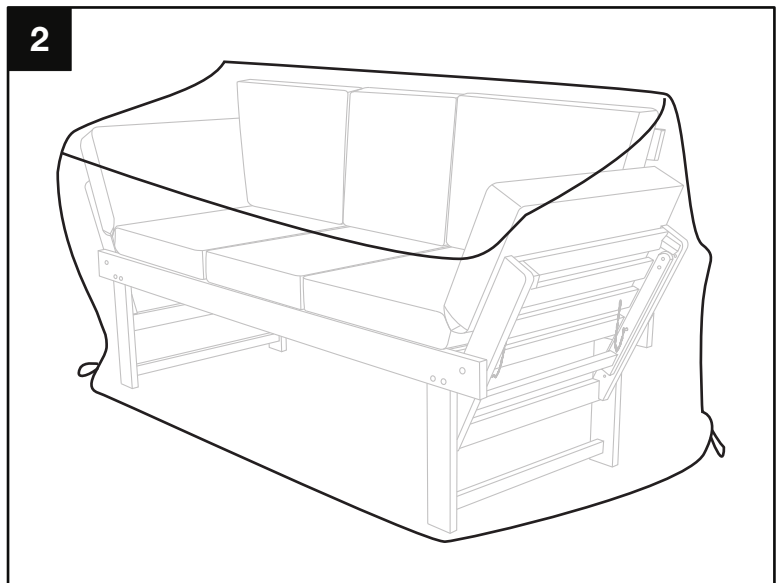

# Limited Warranty

## **JAY TRENDS SALES LIMITED NINETY (90) DAYS WARRANTY**

Jay Trends warrants your new unit product will be free from defects in material and workmanship for ninety (90) days from the date of purchase.

### **Conditions and Limitations**

Jay Trends warrants its products against manufacturing defects to the original purchaser only, and is subject to the following conditions and limitations:

This factory warranty is non-transferable and may not be extended what-so-ever by any of our representatives.

The product must be assembled, maintained, and operated in accordance with the printed instructions accompanying it.

This limited warranty does not cover damages caused by misuse, lack of maintenance, hostile environments, accident, alterations, abuse or neglect and parts installed from other manufacturers will nullify this warranty. Discoloration to plastic parts from chemical cleaners or UV exposure is not covered by this warranty.

Any damages to the product due to weather damage, hail, rough handling, damaging chemicals or cleaners will not be the responsibility of Jay Trends.

This limited warranty does not cover any scratches, dents, painted finishes, corrosion or discoloring by heat, abrasive and chemical cleaners, nor chipping or cracks on the wood, nor any components used in the installation of the product.

The bill of sale or copy will be required when making any warranty claims from Jay Trends.

All parts replaced under the Limited Ninety (90) Days Warranty Policy are subject to a single claim.

Jay Trends will not be responsible for the installation, labor, or any other costs related to the re-installation of a warranted part, and such expenses are not covered by this warranty.

Jay Trends reserves the right to have its representative inspect any product or part prior to honoring any warranty claim. Jay Trends shall not be liable for any transportation charges, labor costs, or export duties.

### **Replacement Parts**

In the event that an item has been lost or damaged either by the manufacturer or in shipping you may request a replacement. Replacement parts are not available for all units and only given at Jay Trends' discretion. We will assess any damage and find a solution, which could include ordering and shipping a replacement to you. No replacements are available for discontinued items or repackaged (open box) products. Please call Jay Trends Customer Service at 1-877-387-3639 for replacement parts before returning the damaged item. Please have the following information, which can be found in your instruction manual, ready before you call Customer Service.

1. Model Number of Item # \_\_\_\_\_
2. Shipping Address \_\_\_\_\_.
3. A picture of the damaged part is required.
4. Pictures should be sent to [custserv@jaytrends.com](mailto:custserv@jaytrends.com).
5. Proof of purchase with date \_\_\_\_\_
6. All claims must be received within 30 days of receipt of order.

Jay Trends Sales  
1901 Aut. Transcanadienne  
Dorval, QC H9P 1J1, Canada  
[www.jaytrends.com](http://www.jaytrends.com)  
Customer Service: 1-877-387-3639 in USA & Canada  
[custserv@jaytrends.com](mailto:custserv@jaytrends.com)